



scan this

PLEASE JOIN US ON

CHURCHCENTER

DEFENDERS APOLOGETICS



WEEK
7



DEFENDERS

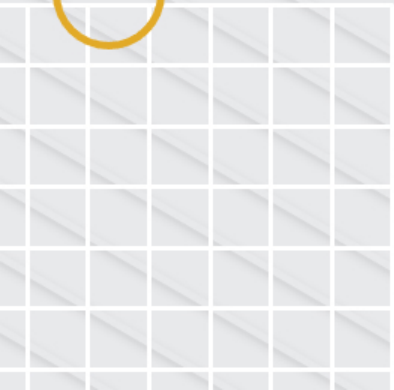

Defending your faith
with reason and precision





TODAY'S TOPICS

Who was (is) Jesus?

Did Jesus rise from the dead?

1. The reliability of NT documents (criteria of authenticity)
2. Who did Jesus claim to be? How did he prove his claims?
3. Facts and evidence for Jesus' resurrection
4. Theories and hypotheses to explain the evidence

You can watch the recording of this session on YouTube at

youtube.com/@defendersapologetics

Questions? Email us: defendersapologetics@gmail.com





THE

HISTORICAL

JESUS

By

Gary Habermas

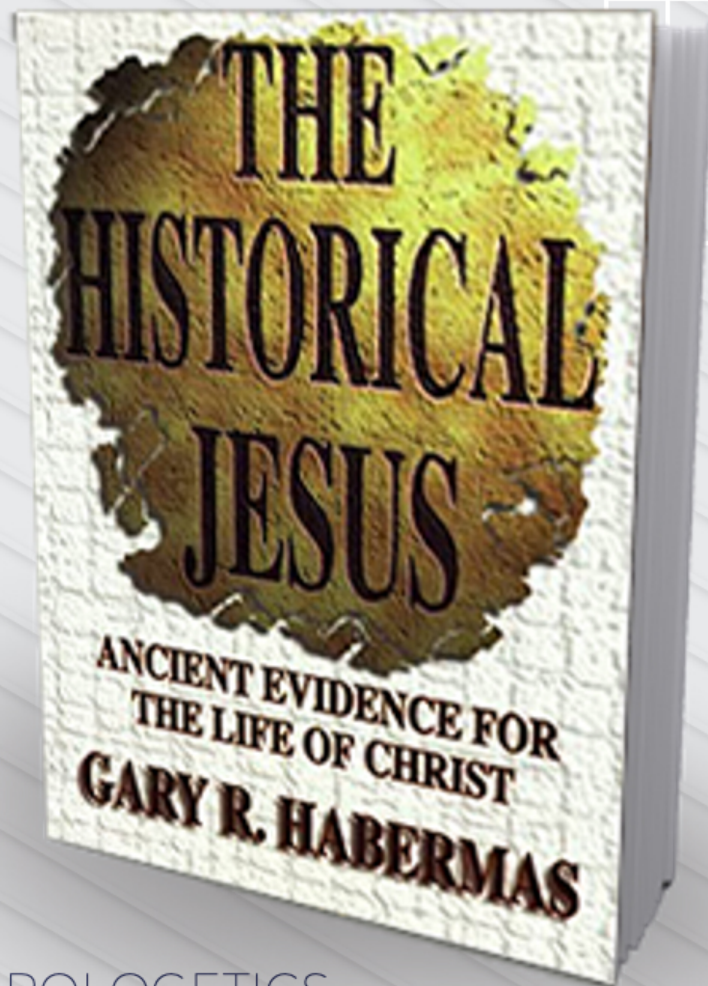

TEXTUAL CRITICISM

→ the study of historical documents with the goal of learning the original **meaning** and **authenticity**

[wts.edu](https://www.wts.edu)

APOLOGETICS

FRAGMENTS OF TRUTH

ANCIENT DOCUMENTS,
NEW DISCOVERIES



DEFENDERS APOLOGETICS

Imagine you've just discovered an ancient piece of papyrus with text written on it about Jesus...



CRITERIA FOR AUTHENTICITY



HISTORICAL FIT

The incident fits in known historical facts of the time and place.



DISSIMILARITY

The incident is unlike earlier Jewish ideas and/or unlike later Christian ideas.



INDEPENDENT, EARLY SOURCES

The incident is related in multiple sources, which are near to the time when the incident is said to have occurred and which don't rely on each other or on a common source.



SEMITISMS

Traces of Hebrew or Aramaic language (spoken by Jesus' countrymen) appear in the story.



COHERENCE

The incident fits in with the facts already established about Jesus.



EMBARRASSMENT

The incident is awkward or unproductive for the early Christian church.



NUMBER OF MANUSCRIPTS

25000
20000
15000
10000
5000
0



New Testament



Homer
(The Iliad & The Odyssey)



Suetonius
(Roman history)



THE LINCHPIN OF CHRISTIANITY

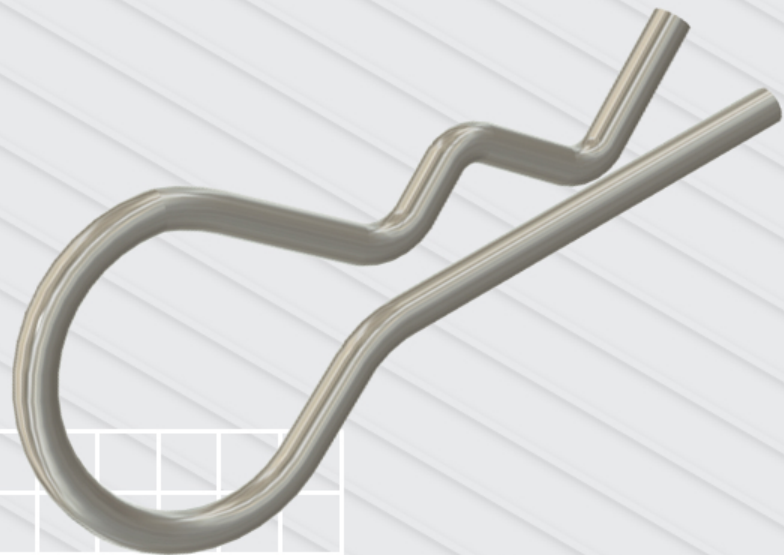

1 Corinthians 15:12-19



WHICH OF THESE FACTS SEEMS MOST CONVINCING TO YOU?

Which do you suppose a non-believer might find most compelling?





WHICH NATURALISTIC EXPLANATION DO YOU SUSPECT IS MOST POPULAR?

Which of the facts do you think a denier would most want to reject? How would you respond?





WEEK
7



DEFENDERS

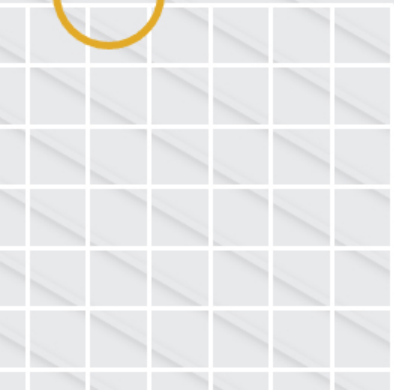

Defending your faith
with reason and precision

